

REMY INC.

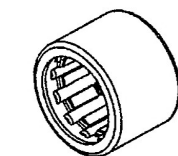

VIEW
SCALE 2.0

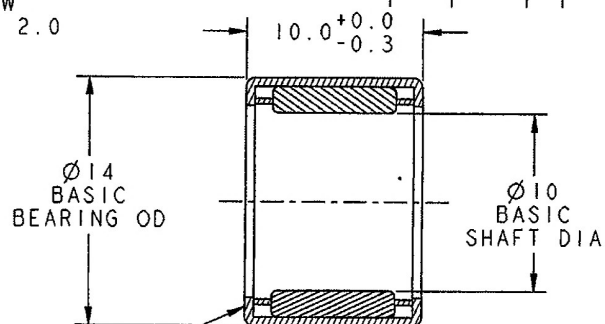

MANUFACTURER IDENTIFICATION

- I. FOR INSPECTION PURPOSES
PRESS BEARING INTO 13.980 RING GAGE.
PLUG BORE WITH 10.0 ^{+0.031}(NO GO) _{-0.013}(GO) GAGE
ALL GAGES TO BE PRECISION QUALITY.
THE ROLLER BEARING MAY BE OUT OF ROUND BEFORE
INSTALLATION. AN IMPROPER METHOD OF INSPECTION
IS TO GAGE OUTSIDE DIAMETER AND PLUG BORE WHEN
BEARING IS FREE.
- II. RECOMMENDED HOUSING BORE AND SHAFT DIAMETER
LIGHT METAL HOUSING-----Ø14R6(Ø13.969-Ø13.980)
ROTATING SHAFT-----Ø10h5(Ø9.994-Ø10.000)
- III. BASIC LOAD RATINGS
C = 4400N
C₀ = 5100N
- IV. LUBRICATION BEARING WITH DOW CORNING MOLYKOTE
7514 0.14-0.22GRAMS OR EQUIVALENT GRASE

INA HK1010B GKSL 978 BEARING OR EQUIVALENT

12Aug05		SALES RELEASE DATE			
23Jul05		ENGINEERING RELEASE NOTICE		SGK	
D L	DATE	SYM	REVISION RECORD	AUTH	DR CK

PART NO.		10513771																									
THE FOLLOWING APPLY UNLESS OTHERWISE SPECIFIED PERFECT FORM REQUIRED FOR FEATURES-OF-SIZE AT MMC. TRUE POSITION TOLERANCES, AND RELATED DATUMS, APPLY AT CONDITION OF SIZE INDICATED IN FEATURE CONTROL FRAME. OTHER GEOMETRIC TOLERANCES, AND RELATED DATUMS, APPLY RFS. SEPARATE TRUE POSITION CALLOUTS MAY BE GAGED SEPARATELY REGARDLESS OF DATUM REFERENCE																											
GEOMETRIC DRAWING SYMBOLS <table border="0"> <tr> <td>□ FLAT</td> <td>⊥ PERPENDICULAR</td> <td>⌒ PROFILE OF LINE</td> </tr> <tr> <td>— STRAIGHT</td> <td>⊘ CYLINDRICAL</td> <td>⌒ PROFILE OF SURFACE</td> </tr> <tr> <td>○ ROUNDNESS</td> <td>∥ PARALLEL</td> <td>∅ DIAMETER</td> </tr> <tr> <td>∠ ANGULAR</td> <td>⊕ TRUE POSITION</td> <td>≡ SYMMETRICAL</td> </tr> <tr> <td>⊗ MAXIMUM MATL CONDITION (MMC)</td> <td>↗ CIRCULAR RUNOUT</td> <td></td> </tr> <tr> <td>⊘ LEAST MATL CONDITION (LMC)</td> <td>↗ TOTAL RUNOUT</td> <td></td> </tr> <tr> <td>⊗ REGARDLESS OF FEATURE SIZE</td> <td></td> <td></td> </tr> <tr> <td>⊗ PROJECTED TOLERANCE ZONE</td> <td></td> <td></td> </tr> </table>				□ FLAT	⊥ PERPENDICULAR	⌒ PROFILE OF LINE	— STRAIGHT	⊘ CYLINDRICAL	⌒ PROFILE OF SURFACE	○ ROUNDNESS	∥ PARALLEL	∅ DIAMETER	∠ ANGULAR	⊕ TRUE POSITION	≡ SYMMETRICAL	⊗ MAXIMUM MATL CONDITION (MMC)	↗ CIRCULAR RUNOUT		⊘ LEAST MATL CONDITION (LMC)	↗ TOTAL RUNOUT		⊗ REGARDLESS OF FEATURE SIZE			⊗ PROJECTED TOLERANCE ZONE		
□ FLAT	⊥ PERPENDICULAR	⌒ PROFILE OF LINE																									
— STRAIGHT	⊘ CYLINDRICAL	⌒ PROFILE OF SURFACE																									
○ ROUNDNESS	∥ PARALLEL	∅ DIAMETER																									
∠ ANGULAR	⊕ TRUE POSITION	≡ SYMMETRICAL																									
⊗ MAXIMUM MATL CONDITION (MMC)	↗ CIRCULAR RUNOUT																										
⊘ LEAST MATL CONDITION (LMC)	↗ TOTAL RUNOUT																										
⊗ REGARDLESS OF FEATURE SIZE																											
⊗ PROJECTED TOLERANCE ZONE																											
DO NOT SCALE. CAD MATH MODEL. CHANGE RESTRICTED. NO MANUAL CHANGES PERMITTED.		THIRD ANGLE PROJECTION 																									
DIMENSIONS ARE IN MILLIMETERS U.O.S. ONE PLACE ± 0.3 TWO PLACE ± ANGLE ± 1°																											
KEY PRODUCT CHARACTERISTIC Ⓢ SAFETY/COMPLIANCE Ⓢ FIT/FUNCTION. KPC NUMBERS MAY NOT BE SEQUENTIAL DUE TO CHANGE. NUMBERS ARE NOT REUSED 0 TOTAL KPC ON THIS PART NO. 0 LAST KPC NO. USED.																											
ORIGINAL REF DESCRIPTION 113275 BEARING																											
APPLIED SPECIFICATIONS MS201-02 PROHIBITION OF USE OF HEAVY METAL FOR AUTOMOTIVE PARTS																											
MATL BASIC SPEC SEE NOTE																											
PURCHASING SPEC PURCHASED <table border="0"> <tr> <td>DWG DATE 07AP05</td> <td>DR S.G.KIM</td> <td>07AP05</td> </tr> <tr> <td>SCALE 4.0</td> <td>CK J.G.Yoo</td> <td>23Jul05</td> </tr> <tr> <td>FIRST USED</td> <td>APPR K.B.Noh</td> <td>23Jul05</td> </tr> <tr> <td>8000129 MOTOR</td> <td>APPR BARANSU</td> <td>01JL05</td> </tr> </table>				DWG DATE 07AP05	DR S.G.KIM	07AP05	SCALE 4.0	CK J.G.Yoo	23Jul05	FIRST USED	APPR K.B.Noh	23Jul05	8000129 MOTOR	APPR BARANSU	01JL05												
DWG DATE 07AP05	DR S.G.KIM	07AP05																									
SCALE 4.0	CK J.G.Yoo	23Jul05																									
FIRST USED	APPR K.B.Noh	23Jul05																									
8000129 MOTOR	APPR BARANSU	01JL05																									
NAME BEARING																											
SHEET NO. 1 OF 1		CAT NO																									
PART NO.		ORG SIZE																									
10513771		A3																									