

NOTE:

- 1- MATERIAL : ASTM148 (120-95) 95.000 PSI MIN. YIELD
- 2- STRESS RELIEVE CASTING
- 3- SAND BLAST CLEAN AFTER STRESS RELIEVING
- 4- ALL RADIUS TO BE 1/4R EXCEPT AS NOTED
- 5- THIS CASTING IS TO MAKE PART #QFH4083
- 6- ADD REINFORCING SEE DETAIL "E"
- 7- ALL DIMENSIONS WITH "HOLD" NOTATION  
MUST BE WITH IN TOLERANCE SPECIFIED

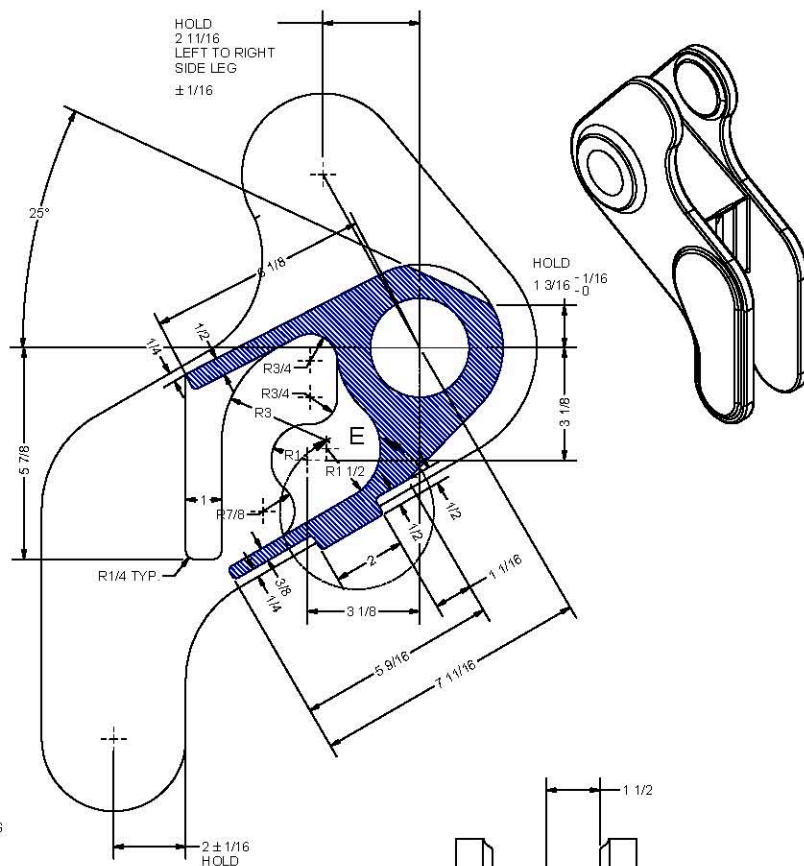

SECTION B-B  
SCALE 3/8

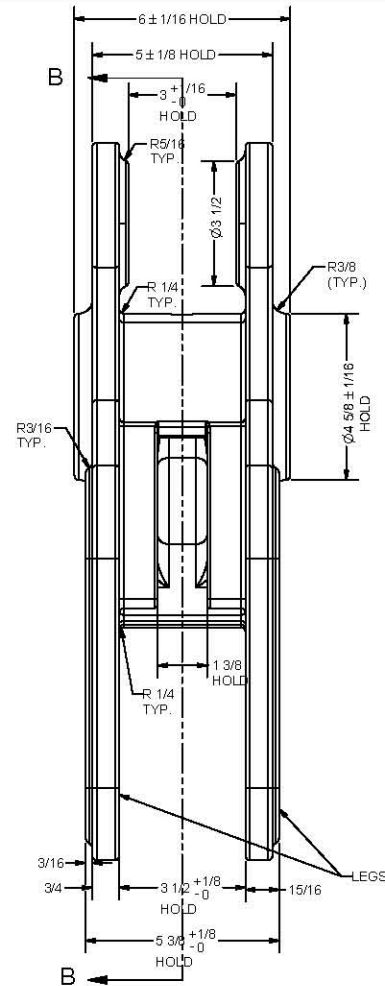
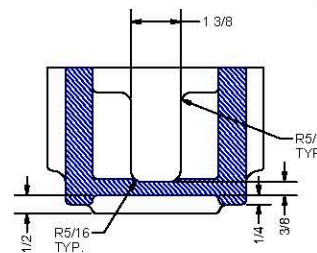

SECTION C-C  
SCALE 3 / 8

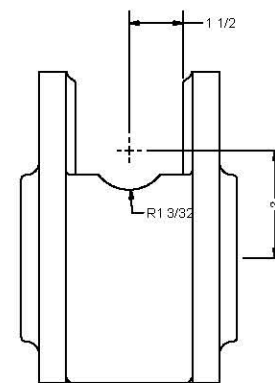

SECTION D-D  
SCALE 3 / 8

PAGE / SHEET: 1 / 1		4		OCT/12/99		SEE NOTE #6		IIC	
THE INFORMATION CONTAINED HEREIN IS PROPRIETARY TO AND IS NOT BE REPRODUCED, COMMUNICATED TO A THIRD PERSON OR USE IN ANY MANNER WHATSOEVER WITHOUT THE EXPRESSED WRITTEN PERMISSION OF REPRESENTATIVE.									
REV. DATE					MODIF. INT.				
REV. 1 / 4 / 99									
CASTING INNER ARM									
NO. / DEL. / MODEL				MATERIALS				SCALE:	
QFH				SEE NOTE				(0,38:1)	
DIMENSION / DRAWING BY:				VOLUME / CATERG / CHECKED BY:				DATE:	
DB				RMP				2003-09-09	
ADMINISTRATIVE / PROJECT / QFH4083				BY THE PARTY / QFH7009				SEE	
TOLERANCES UNLESS OTHERWISE SPECIFIED ARE: FRACT : $\pm 1/64"$				SAUF INDICATION CONTRAIRE, LES TOLERANCES SONT LES SUIVANTES: DEC: $\pm 0.005"$					