

NO.	DATE	REVISIONS	EO NO	DRWN	CHECK	APRD
		ORIGINAL ON CAD				
01AA	2012-05-30	RE-DRAWN (DBS-CWG)	PL100100	J.J.LIB	R.C.BORIS	J.B.BON

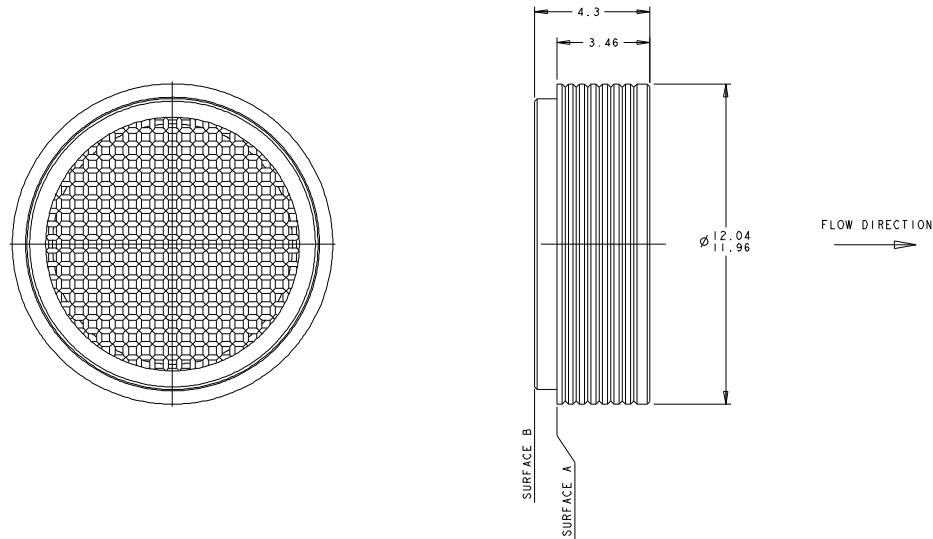

AFTER PLACING INSERT INTO A DRILLED INSTALLATION HOLE, DRIVE IN INSERT WITH 5000 N (510 kgf) FORCE, USING INSTALLATION TOOL CCRT090087SS. EXPOSED ENDS (SURFACES A AND B) WILL BE FLUSH WITHIN 0.25 OF EACH OTHER

THE LOHM IS A MEASURE OF RESISTANCE TO FLUID FLOW. EXAMPLE: ONE LOHM WILL PERMIT A FLOW OF 378 LITERS/MINUTE OF WATER AT 172 kPa AT 27°C

MATERIALS: BODY, PIN AND SCREEN ARE STAINLESS STEEL

LOHM RATE: (45 LOHMS)

SCREEN: SINGLE PLAIN DUTCH WEAVE 125 MICRON ABSOLUTE

SCREEN OPEN AREA: 14.5 SQ. MM
SCREEN ROB #: 1.28

MAXIMUM FLOW RATE: 38.9 LPM

FOR INSTALLATION HOLE SPECIFICATIONS REFER TO IMH P/N 11NST010643S

SCREEN CONFIGURATION: (SINGLE 125)

UNLESS OTHERWISE SPECIFIED

MACHINED DIMENSIONS TOLERANCE ± 0.13

SURFACE FINISH MAXIMUM (R_a)

SURFACES MUST BE FREE OF SCRATCHES
BURRS & PITS

PART MUST BE FREE OF SHARP EDGES
AND ANY FOREIGN MATERIAL RESULTING
FROM MANUFACTURING PROCESSES

CHANGES AFFECTING DESIGN, COMPOSITION OR
PROCESSING OF THE PART PREVIOUSLY APPROVED
FOR PRODUCTION REQUIRE PRIOR APPROVAL FROM
VISTEON PRODUCT ENGINEERING.
REFER TO ISO/TS 16949:2002.

MANUFACTURING APPROVAL OF FIRST PRODUCTION
SHIPMENT FROM EACH SUPPLIER IS REQUIRED
PRIOR TO AUTHORIZATION FOR USE AS PER THE
PPAP MANUAL

FOR PURPOSES OF GEOMETRIC TOLERANCING ALL
DIMENSIONAL INFORMATION CONTAINED IN THE
CAD MODEL IS BASIC

FOR CURRENT RELEASE STATUS SEE
VISTEON ENGINEERING NOTICE

01AA

QTY	PART NUMBER	PART NAME	NO	MATERIAL	REMARK
	PL F009FMCD0A01 001	SCREEN-EVAP			
	REFERENCE PART NUMBER	MATERIAL	FINISH	CARLINE	
	VPDKAH-6B706-A			ESC 27N	
DRWN	J.J.LIB 2012-05-30	SHEET	SCALE	WEIGHTS	IN ANGLE TYPE
CHECKED	C.M.MOON 2012-05-30			KG	
REVIEWED	R.C.BORIS 2012-05-30	UNIT			
APRD	J.B.BON 2012-05-30	KG / INCH			
1. THE DRAWING OR TECHNICAL INFORMATION SHALL BE THE PROPERTY OF VISTEON. IT IS TO BE USED ONLY FOR THE PURPOSES SPECIFIED AND NOT BE REPRODUCED OR TRANSMITTED IN ANY FORM OR BY ANY MEANS, ELECTRONIC OR MECHANICAL, INCLUDING PHOTOCOPYING, RECORDING, OR BY ANY INFORMATION STORAGE AND RETRIEVAL SYSTEM. 2. THE DRAWING OR TECHNICAL INFORMATION IS UNCONTROLLED. IT IS THE USER'S RESPONSIBILITY TO OBTAIN THE LATEST EDITION OF THE DRAWING OR TECHNICAL INFORMATION. 3. THE USER SHALL BE RESPONSIBLE FOR THE CORRECTNESS OF THE INFORMATION CONTAINED IN THE DRAWING OR TECHNICAL INFORMATION. 4. THE USER SHALL BE RESPONSIBLE FOR THE CORRECTNESS OF THE INFORMATION CONTAINED IN THE DRAWING OR TECHNICAL INFORMATION.					
1. DRAWING INFORMATION SHOULD BE THE PROPERTY OF VISTEON. IT IS TO BE USED ONLY FOR THE PURPOSES SPECIFIED AND NOT BE REPRODUCED OR TRANSMITTED IN ANY FORM OR BY ANY MEANS, ELECTRONIC OR MECHANICAL, INCLUDING PHOTOCOPYING, RECORDING, OR BY ANY INFORMATION STORAGE AND RETRIEVAL SYSTEM. 2. IN CASE OF DESIGN CHANGES FROM PREVIOUS EDITIONS, THE USER SHALL BE RESPONSIBLE FOR OBTAINING THE LATEST EDITION OF THE DRAWING OR TECHNICAL INFORMATION. 3. THE USER SHALL BE RESPONSIBLE FOR THE CORRECTNESS OF THE INFORMATION CONTAINED IN THE DRAWING OR TECHNICAL INFORMATION.					