

VIEW IN CIRCLE D
SCALE 20:1

SECTION A

VIEW IN CIRCLE
SCALE 20:1

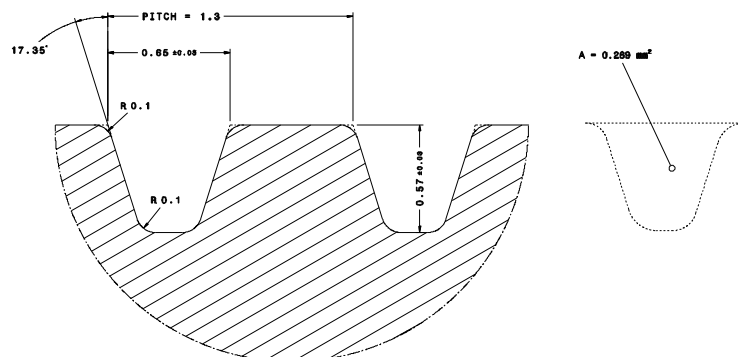

VIEW IN CIRCLE C
SCALE 100:1

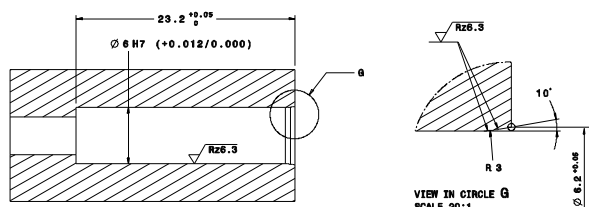

VIEW IN CIP
SCALE 20:1

MATING PART DIMENSIONS (FOR INFORMATION ONLY)

GENERAL TOLERANCES

ONLY DIMENSION WITHOUT TOLERANCES	
NOMINAL DIM. RANGE	PERMISSIBLE TOLERANCE
UP TO 1	±0.08
MORE THAN 1 TO 3	±0.09
3 TO 8	±0.10
8 TO 10	±0.11
10 TO 15	±0.13
15 TO 22	±0.15
22 TO 30	±0.17
30 TO 40	±0.19

UNLESS OTHERWISE SPECIFIED

MATERIAL: PESU-GF 20
WITH VISCOSITY NUMBER 56±3cm²/g
(IN 0.01 g/ml PHENOL/1,2, ORTHO-DICHLOROBENZOL, 1:1)
TEST METHOD ISO 307, 1157, 1628

COLOR: BLACK

VOLUME: 385mm³

BURRS ON SPLIT LINE MAXIMAL 0,02mm PERMISSIBLE.
NO MEASUREMENT OF PARTS ON SPLIT OFF AREA

 NOMINAL DIMENSION OF SPIRAL NOZZLE TOOLING $\Delta T = 0,010 \text{ mm}$

ALL DIMENSIONS APPLY AT A TEMPERATURE OF 20°C

ALL 4 TOOLING CAVITIES HAVE TO BE CREATED IN NOMINAL DIMENSIONS ACCORDING TO DRAWING AND TOLERANCE FIELDS

ALL INJECTION MOLDING TOOLINGS HAVE TO BE MEASURED; REPORTED AND COMPARED TO BE IN EQUAL DIMENSIONS; TOLERANCES AND QUALITY WITH RESPECT TO 1ST TOOLING CAVITY ACCORDING TO PRODUCTION OF 2nd, 3rd & 4th TOOLING CAVITY MEASUREMENT REPORTS NECESSARY FOR COMPARISON (FEEDER OFFSET, TOLERANCING, ETC.)

ALL EXTERIOR SURFACES AT LEAST VDI 3400 REF 24 OR BETTER

TOOL SPLIT FLASH MAX. 0,02mm SEPARATELY TO DIAMETER
GATE VESTIGE MAXIMAL 0,1mm

TEST FLOW RATE (AIR): 7 ± 0.2 l/min AT 5000 RPM & 6 bar

NO RADII ALLOWED ON EDGES WHICH ARE SHOWN
AS SHARP EDGES IN 3D.

PARTS MUST BE FREE OF SCRATCHES, BURRS,
SHARP EDGES, DAMAGES AND ANY FOREIGN MATERIAL
RESULTING FROM MANUFACTURING PROCESS

FOR CURRENT RELEASE STATUS SEE VISTEON
ENGINEERING NOTICE

FOR PURPOSES OF GEOMETRIC TOLERANCING ALL
DIMENSIONAL INFORMATION CONTAINED IN THE
CAD MODEL IS BASIC

CHANGES AFFECTING DESIGN, COMPOSITION OR
PROCESSING OF THE PART PREVIOUSLY APPROVED
FOR PRODUCTION REQUIRE PRIOR APPROVAL FROM
HALLA VISTEON CLIMATE CONTROL CORP. PRODUCT ENGINEERING

MANUFACTURING APPROVAL OF FIRST PRODUCTION
SHIPMENT FROM EACH SUPPLIER IS REQUIRED PRIOR TO
AUTHORIZATION FOR USE AS PER THE PPAP MANUAL

FOR THE PURPOSES OF GEOMETRIC TOLERANCING ALL
DIMENSIONAL INFORMATION CONTAINED IN THE
CAD MODEL IS BASIC.

제품 공급자는 #1, #2, #3, #4, #5, #6, #7, #8, #9, #10, #11, #12, #13, #14, #15, #16, #17, #18, #19, #20, #21, #22, #23, #24, #25, #26, #27, #28, #29, #30, #31, #32, #33, #34, #35, #36, #37, #38, #39, #40, #41, #42, #43, #44, #45, #46, #47, #48, #49, #50, #51, #52, #53, #54, #55, #56, #57, #58, #59, #60, #61, #62, #63, #64, #65, #66, #67, #68, #69, #70, #71, #72, #73, #74, #75, #76, #77, #78, #79, #80, #81, #82, #83, #84, #85, #86, #87, #88, #89, #90, #91, #92, #93, #94, #95, #96, #97, #98, #99, #100, #101, #102, #103, #104, #105, #106, #107, #108, #109, #110, #111, #112, #113, #114, #115, #116, #117, #118, #119, #120, #121, #122, #123, #124, #125, #126, #127, #128, #129, #130, #131, #132, #133, #134, #135, #136, #137, #138, #139, #140, #141, #142, #143, #144, #145, #146, #147, #148, #149, #150, #151, #152, #153, #154, #155, #156, #157, #158, #159, #160, #161, #162, #163, #164, #165, #166, #167, #168, #169, #170, #171, #172, #173, #174, #175, #176, #177, #178, #179, #180, #181, #182, #183, #184, #185, #186, #187, #188, #189, #190, #191, #192, #193, #194, #195, #196, #197, #198, #199, #200, #201, #202, #203, #204, #205, #206, #207, #208, #209, #210, #211, #212, #213, #214, #215, #216, #217, #218, #219, #220, #221, #222, #223, #224, #225, #226, #227, #228, #229, #230, #231, #232, #233, #234, #235, #236, #237, #238, #239, #240, #241, #242, #243, #244, #245, #246, #247, #248, #249, #250, #251, #252, #253, #254, #255, #256, #257, #258, #259, #260, #261, #262, #263, #264, #265, #266, #267, #268, #269, #270, #271, #272, #273, #274, #275, #276, #277, #278, #279, #280, #281, #282, #283, #284, #285, #286, #287, #288, #289, #290, #291, #292, #293, #294, #295, #296, #297, #298, #299, #300, #301, #302, #303, #304, #305, #306, #307, #308, #309, #310, #311, #312, #313, #314, #315, #316, #317, #318, #319, #320, #321, #322, #323, #324, #325, #326, #327, #328, #329, #330, #331, #332, #333, #334, #335, #336, #337, #338, #339, #340, #341, #342, #343, #344, #345, #346, #347, #348, #349, #350, #351, #352, #353, #354, #355, #356, #357, #358, #359, #360, #361, #362, #363, #364, #365, #366, #367, #368, #369, #370, #371, #372, #373, #374, #375, #376, #377, #378, #379, #380, #381, #382, #383, #384, #385, #386, #387, #388, #389, #390, #391, #392, #393, #394, #395, #396, #397, #398, #399, #400, #401, #402, #403, #404, #405, #406, #407, #408, #409, #410, #411, #412, #413, #414, #415, #416, #417, #418, #419, #420, #421, #422, #423, #424, #425, #426, #427, #428, #429, #430, #431, #432, #433, #434, #435, #436, #437, #438, #439, #440, #441, #442, #443, #444, #445, #446, #447, #448, #449, #450, #451, #452, #453, #454, #455, #456, #457, #458, #459, #460, #461, #462, #463, #464, #465, #466, #467, #468, #469, #470, #471, #472, #473, #474, #475, #476, #477, #478, #479, #480, #481, #482, #483, #484, #485, #486, #487, #488, #489, #490, #491, #492, #493, #494, #495, #496, #497, #498, #499, #500, #501, #502, #503, #504, #505, #506, #507, #508, #509, #510, #511, #512, #513, #514, #515, #516, #517, #518, #519, #520, #521, #522, #523, #524, #525, #526, #527, #528, #529, #530, #531, #532, #533, #534, #535, #536, #537, #538, #539, #540, #541, #542, #543, #544, #545, #546, #547, #548, #549, #550, #551, #552, #553, #554, #555, #556, #557, #558, #559, #560, #561, #562, #563, #564, #565, #566, #567, #568, #569, #570, #571, #572, #573, #574, #575, #576, #577, #578, #579, #580, #581, #582, #583, #584, #585, #586, #587, #588, #589, #590, #591, #592, #593, #594, #595, #596, #597, #598, #599, #600, #601, #602, #603, #604, #605, #606, #607, #608, #609, #610, #611, #612, #613, #614, #615, #616, #617, #618, #619, #620, #621, #622, #623, #624, #625, #626, #627, #628, #629, #630, #631, #632, #633, #634, #635, #636, #637, #638, #639, #640, #641, #642, #643, #644, #645, #646, #647, #648, #649, #650, #651, #652, #653, #654, #655, #656, #657, #658, #659, #660, #661, #662, #663, #664, #665, #666, #667, #668, #669, #670, #671, #672, #673, #674, #675, #676, #677, #678, #679, #680, #681, #682, #683, #684, #685, #686, #687, #688, #689, #690, #691, #692, #693, #694, #695, #696, #697, #698, #699, #700, #701, #702, #703, #704, #705, #706, #707, #708, #709, #710, #711, #712, #713, #714, #715, #716, #717, #718, #719, #720, #721, #722, #723, #724, #725, #726, #727, #728, #729, #730, #731, #732, #733, #734, #735, #736, #737, #738, #739, #740, #741, #742, #743, #744, #745, #746, #747, #748, #749, #750, #751, #752, #753, #754, #755, #756, #757, #758, #759, #760, #761, #762, #763, #764, #765, #766, #767, #768, #769, #770, #771, #772, #773, #774, #775, #776, #777, #778, #779, #780, #781, #782, #783, #784, #785, #786, #787, #788, #789, #790, #791, #792, #793, #794, #795, #796, #797, #798, #799, #800, #801, #802, #803, #804, #805, #806, #807, #808, #809, #810, #811, #812, #813, #814, #815, #816, #817, #818, #819, #820, #821, #822, #823, #824, #825, #826, #827, #828, #829, #830, #831, #832, #833, #834, #835, #836, #837, #838, #839, #840

Q71	PAGE NUMBER	PAGE VALUE	NO	NATIONAL	REMARK
PAGE NUMBER		PAGE VALUE		PAGE VALUE	
PL A301FLB001		000	00000000		00000000
REFERENCE NUMBER		REFERENCE NUMBER		REFERENCE NUMBER	
VIRIANA-GRIN-00		VIRIANA-GRIN-00		VIRIANA-GRIN-00	
OWNER	OWNER	DATE	SCALE	HEIGHT	TYPE
CHANGED	CHANGED	DATE	SCALE	HEIGHT	TYPE
REMARKS	REMARKS	DATE	SCALE	HEIGHT	TYPE
APPRO	APPRO	DATE	SCALE	HEIGHT	TYPE
<p>1. VIRIANA-GRIN-00</p> <p>2. VIRIANA-GRIN-00</p> <p>3. VIRIANA-GRIN-00</p> <p>4. VIRIANA-GRIN-00</p> <p>5. VIRIANA-GRIN-00</p> <p>6. VIRIANA-GRIN-00</p> <p>7. VIRIANA-GRIN-00</p> <p>8. VIRIANA-GRIN-00</p> <p>9. VIRIANA-GRIN-00</p> <p>10. VIRIANA-GRIN-00</p> <p>11. VIRIANA-GRIN-00</p> <p>12. VIRIANA-GRIN-00</p> <p>13. VIRIANA-GRIN-00</p> <p>14. VIRIANA-GRIN-00</p> <p>15. VIRIANA-GRIN-00</p> <p>16. VIRIANA-GRIN-00</p> <p>17. VIRIANA-GRIN-00</p> <p>18. VIRIANA-GRIN-00</p> <p>19. VIRIANA-GRIN-00</p> <p>20. VIRIANA-GRIN-00</p> <p>21. VIRIANA-GRIN-00</p> <p>22. VIRIANA-GRIN-00</p> <p>23. VIRIANA-GRIN-00</p> <p>24. VIRIANA-GRIN-00</p> <p>25. VIRIANA-GRIN-00</p> <p>26. VIRIANA-GRIN-00</p> <p>27. VIRIANA-GRIN-00</p> <p>28. VIRIANA-GRIN-00</p> <p>29. VIRIANA-GRIN-00</p> <p>30. VIRIANA-GRIN-00</p> <p>31. VIRIANA-GRIN-00</p> <p>32. VIRIANA-GRIN-00</p> <p>33. VIRIANA-GRIN-00</p> <p>34. VIRIANA-GRIN-00</p> <p>35. VIRIANA-GRIN-00</p> <p>36. VIRIANA-GRIN-00</p> <p>37. VIRIANA-GRIN-00</p> <p>38. VIRIANA-GRIN-00</p> <p>39. VIRIANA-GRIN-00</p> <p>40. VIRIANA-GRIN-00</p> <p>41. VIRIANA-GRIN-00</p> <p>42. VIRIANA-GRIN-00</p> <p>43. VIRIANA-GRIN-00</p> <p>44. VIRIANA-GRIN-00</p> <p>45. VIRIANA-GRIN-00</p> <p>46. VIRIANA-GRIN-00</p> <p>47. VIRIANA-GRIN-00</p> <p>48. VIRIANA-GRIN-00</p> <p>49. VIRIANA-GRIN-00</p> <p>50. VIRIANA-GRIN-00</p> <p>51. VIRIANA-GRIN-00</p> <p>52. VIRIANA-GRIN-00</p> <p>53. VIRIANA-GRIN-00</p> <p>54. VIRIANA-GRIN-00</p> <p>55. VIRIANA-GRIN-00</p> <p>56. VIRIANA-GRIN-00</p> <p>57. VIRIANA-GRIN-00</p> <p>58. VIRIANA-GRIN-00</p> <p>59. VIRIANA-GRIN-00</p> <p>60. VIRIANA-GRIN-00</p> <p>61. VIRIANA-GRIN-00</p> <p>62. VIRIANA-GRIN-00</p> <p>63. VIRIANA-GRIN-00</p> <p>64. VIRIANA-GRIN-00</p> <p>65. VIRIANA-GRIN-00</p> <p>66. VIRIANA-GRIN-00</p> <p>67. VIRIANA-GRIN-00</p> <p>68. VIRIANA-GRIN-00</p> <p>69. VIRIANA-GRIN-00</p> <p>70. VIRIANA-GRIN-00</p> <p>71. VIRIANA-GRIN-00</p> <p>72. VIRIANA-GRIN-00</p> <p>73. VIRIANA-GRIN-00</p> <p>74. VIRIANA-GRIN-00</p> <p>75. VIRIANA-GRIN-00</p> <p>76. VIRIANA-GRIN-00</p> <p>77. VIRIANA-GRIN-00</p> <p>78. VIRIANA-GRIN-00</p> <p>79. VIRIANA-GRIN-00</p> <p>80. VIRIANA-GRIN-00</p> <p>81. VIRIANA-GRIN-00</p> <p>82. VIRIANA-GRIN-00</p> <p>83. VIRIANA-GRIN-00</p> <p>84. VIRIANA-GRIN-00</p> <p>85. VIRIANA-GRIN-00</p> <p>86. VIRIANA-GRIN-00</p> <p>87. VIRIANA-GRIN-00</p> <p>88. VIRIANA-GRIN-00</p> <p>89. VIRIANA-GRIN-00</p> <p>90. VIRIANA-GRIN-00</p> <p>91. VIRIANA-GRIN-00</p> <p>92. VIRIANA-GRIN-00</p> <p>93. VIRIANA-GRIN-00</p> <p>94. VIRIANA-GRIN-00</p> <p>95. VIRIANA-GRIN-00</p> <p>96. VIRIANA-GRIN-00</p> <p>97. VIRIANA-GRIN-00</p> <p>98. VIRIANA-GRIN-00</p> <p>99. VIRIANA-GRIN-00</p> <p>100. VIRIANA-GRIN-00</p>					